



ETG Inc.

8599 Venice Blvd., Unit K
 Phone: + 1 (310) 202-6400
<http://www.etgtech.com/>

Los Angeles, Ca 90034, U. S. A.
 Fax: +1 (310) 22-6406
 EMail: info@etgtech.com

ETG 0603 Super Bright Electro-Optical Characteristics:

ETG PART NUMBER	Lighting Color	Material	V _F (V)		λ (nm)			I _V (mcd)	Internal Circuit
			Typ	Max	λ _D	λ _P	Δλ	Typ	
ETG-0603UC640-130	Red	AlGaInP	1.90	2.40	631	640	23	75	
ETG-0603UC630-130	Red	AlGaInP	1.90	2.40	624	635	25	85	
ETG-0603UC620-130	Orange	AlGaInP	1.90	2.40	615	620	18	100	
ETG-0603UC610-130	Amber	AlGaInP	1.90	2.40	605	610	25	75	
ETG-0603UC590-130	Yellow	AlGaInP	2.00	2.50	588	590	32	85	
ETG-0603AE575-130	Green	AlGaInP	2.10	2.60	578	575	18	50	
ETG-0603CE525-130	True Green	InGaN	3.20	3.80	527	525	40	180	
ETG-0603CE505-130	Turquoise	InGaN	3.30	4.00	509	505	37	180	
ETG-0603CE470-130	Blue	GaNN	3.40	4.00	465	460	68	80	
ETG-0603CE430-130	Blue	GaN/SiC	4.00	4.50	465	430	60	8	

Package Outline

Drawing:

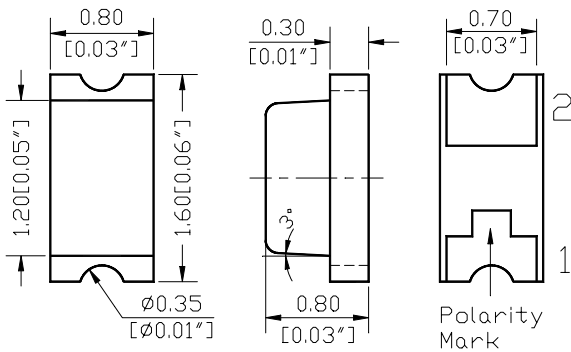

- NOTES**
- All dimensions are in millimeters (inches);
 - Tolerances are ±0.1mm (0.004inch) unless otherwise noted;
 - Resin color: water clear.

*** Soldering iron**

Basic spec is ≤ 5sec when 260°C. If temperature is higher, time should be shorter (+10°C → -1sec). Power dissipation of iron should be smaller than 15W, and temperatures should be controllable. Surface temperature of the device should be under 230°C.

*** Recommended Reflow Soldering Profile.**

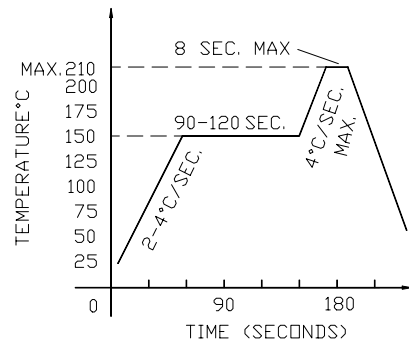

*** Recommended Soldering Pattern For Reflow Soldering**

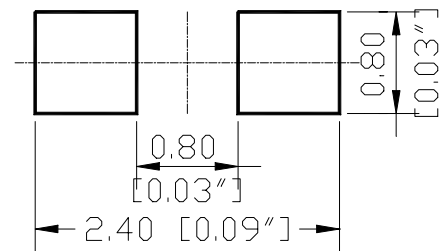



Absolute Maximum Ratings:

Series	I_F (mA)	* I_{FP} (mA)	V_R (V)	T_{OP} (°C)	T_{ST} (°C)
ETG-0603 Series	30	120	5	-20~+80	-20~+100

*Condition for I_{FP} is pulse of 1/10 duty and 0.1msec width

*Tape And Reel Of ETG - 0603 SERIES

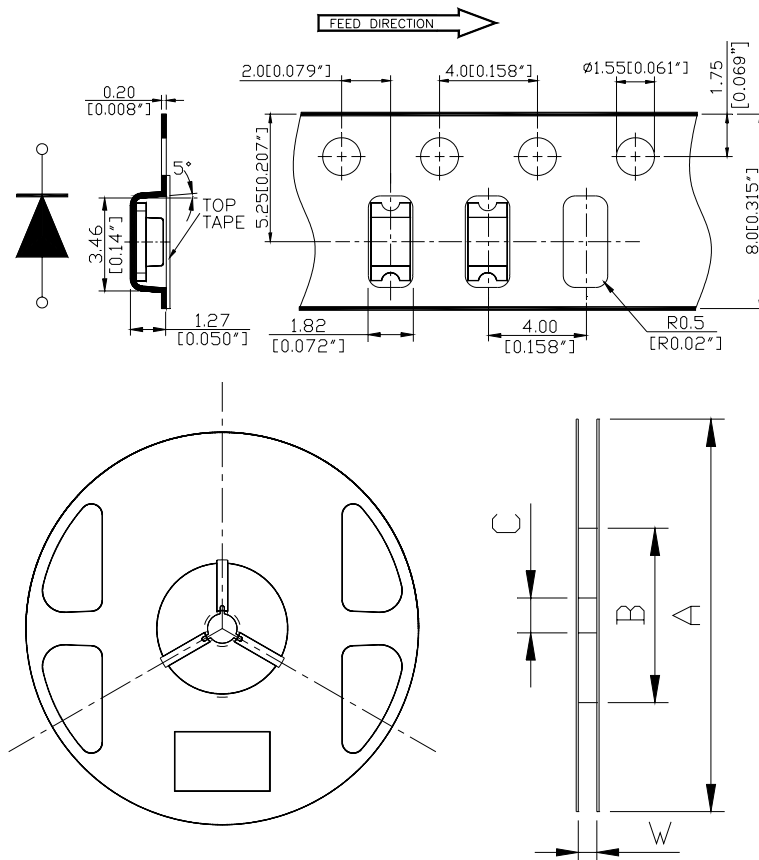

Dimensions per ANSI/EIA
Standard RS-481

*All dimensions are in
Millimeters (inches).*

A	180[7.09]
B	60[2.36]
C	13.5[0.53]
W	8.4[0.33]
Thickness of top cover tape 0.1[0.004"] MAX	

NOTES:

1. Empty component pockets are sealed with top cover tape;
2. Minimum leader length at both ends of the tape is 450 mm;
3. The maximum number of missing lamps is two;
4. The cathode is oriented towards the tape sprocket hole in accordance with ANSI/EIA RS-481 specifications.
5. 3000pcs/Reel